

Owner:
Yonkers Board of Education
28 Wells Avenue
Yonkers, New York

Architect:
The Hall Partnership
42 East 21st Street
New York, New York

CM:
Don Todd Associates, Inc.
One Penn Plaza, Ste 1416
New York, New York

Project Location:
47 Croydon Road
Yonkers, New York

Square Footage:
35,000 sft new construction
3,000 sft renovation



BOCES facilities project for handicapped children. Major components of the new school are:

New Construction:

- Cafetria
- Kitchen
- Gymnasium
- Arts Room
- Exterior Playground
- Classrooms
- Computer Room
- Long Distance Learning Center

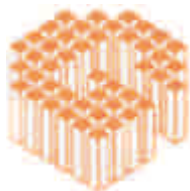
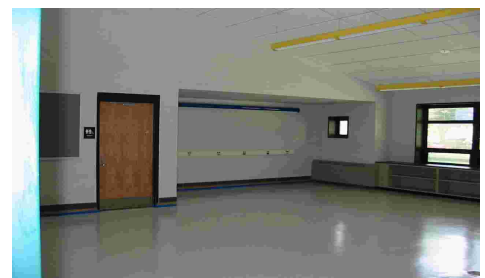

GLENMAN
CORPORATION
THE FUTURE OF CONSTRUCTION

One Odell Plaza
Yonkers, New York 10701
Tel: 914.965.9127
Fax: 914.965.9130
website: www.glenman.com